

# TECHNICAL DATA SHEET • SPECIFICATIONS

## FLUSH REMOVABLE ACCESS DOOR WITH DRYWALL BEAD FLANGE

Screwdriver cam latch, concealed spring pin hinge

AHR-GYP-00

### INSTALLATION

Technical drawing AHR-GYP-00

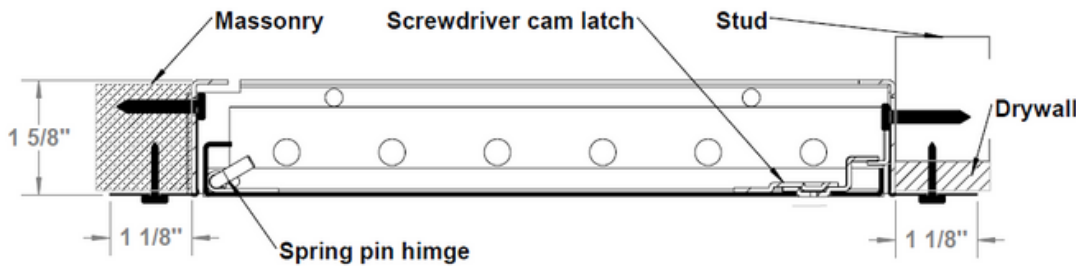

### STANDARD DIMENSIONS AND APPEARANCE

Dimensions • W X H		Number of locks	Weight	
inches	mm		lbs	KG
22 x 30	558 x 762	2	18.1	8.2
22 x 36	558 x 914	2	21.2	9.6
24 x 30	609 x 762	2	19.5	8.9
24 x 36	609 x 914	2	22.8	10.3
24 x 48	609 x 1219	2	29.4	13.3
30 x 30	762 x 762	4	25.0	11.3
30 x 36	762 x 914	4	26.8	12.1
36 x 36	914 x 914	4	31.3	14.2
36 x 48	914 x 1219	4	40.9	18.5
48 x 48	1219 x 1219	4	52.3	23.7

Your odd sizes: Made in 5 days

Rough wall opening is door size + 1/4" or + 6 mm

### OTHER TECHNICAL INFORMATION

The AHU model is recommended for over 2304 sq. inch area or H over 60 inches.  
Maximum dimensions: W ≤ 48 in, H ≤ 60 in, and W × H ≤ 2304 in².

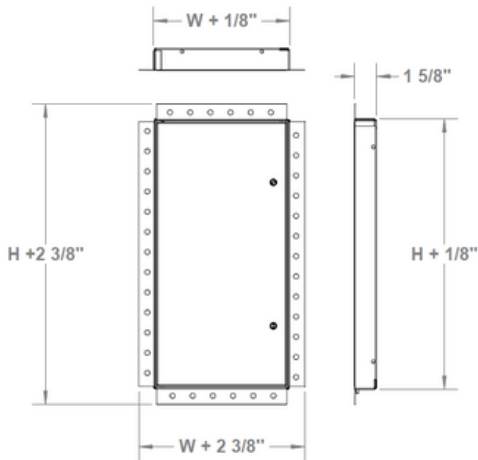

### PROJET DATA

Project:	Date:	QTY	W	H
Architech:				
Dealer:				
Contractor:				
Location:				

### DESCRIPTION AND MATERIAL SPECIFICATION

Material	16 gauge cold rolled steel
Hinge	Pin and spring pin hinge, located on the second dimension (height)
Lock / Latch	Screwdriver operated cam latch in cold-rolled steel
Finish	High quality white powder coat primer
Packaging	Individually wrapped, 1 door per box
Flange	22-gauge galvanized steel, 1 1/8" drywall bead flange
Frame	1 1/8" in depth, made of cold rolled steel

### POPULAR OPTIONS

For complete list of options go to [cendrex.com](https://cendrex.com)

Lock / Latch	Key-operated cylinder cam latch (-10), mortise cam latch preparation (-15, cylinder optional), hex head cam latch (-50)
Handle	4" handle-operated cam latch (-20), 4" handle and key operated cam latch (-25)
Material	Stainless steel (SS)

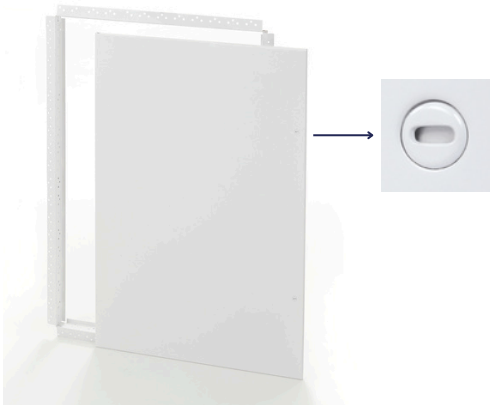

## OPTIONS

This comprehensive list includes all available options. Please consult our catalog or contact our customer service to verify the feasibility of your chosen combination.

### LOW SECURITY LOCKING MECHANISM



- ☐ **35**  
Screwdriver operated  
cam latch



- ☐ **220**  
Screwdriver operated  
cylinder Cam latch



- ☐ **80**  
Ring/tool key operated slam  
latch



- ☐ **55**  
Hex head slam latch and ring key  
operated slam latch



- ☐ **30**  
Slide latch



- ☐ **50**  
Allen hex head cam latch

### HANDLES



- ☐ **25**  
WITH KEY - 4" handle and key  
operated cam latch



- ☐ **100K**  
Key-operated recessed handle  
cam latch with cap over key  
path



- ☐ **20**  
WITHOUT KEY - 4" handle  
operated cam latch



- ☐ **22**  
WITHOUT KEY - 4" handle  
operated slam latch



- ☐ **21**  
WITHOUT KEY  
Fixed 4" handle



- ☐ **26**  
WITHOUT KEY - L handle

### MEDIUM SECURITY LOCKING MECHANISM



- ☐ **10**  
Key-operated cylinder  
cam latch



- ☐ **15**  
Mortise cam latch preparation  
**15C**  
Mortise cam latch preparation,  
keyed differently  
**15CKA**  
Mortise cam latch preparation,  
keyed alike



- ☐ **85**  
Mortise slam latch



- ☐ **85C**  
Mortise slam latch with cylinder  
**85CKA**  
Mortise slam latch cylinder  
keyed alike



- ☐ **90**  
Pinned hex head cam latch



- ☐ **C**  
Cylinder cam latch,  
keyed differently



- ☐ **CKA**  
Cylinder cam latch,  
keyed alike

### MATERIALS



- ☐ **GS**  
Galvanneal steel



- ☐ **AL**  
Aluminum



- ☐ **SS**  
Stainless steel



- ☐ **CR**  
Cold rolled steel

### HIGH SECURITY LOCKING MECHANISM



- ☐ **40**  
Mortise deadbolt lock



- ☐ **40C**  
Mortise Deadbolt Lock with  
Cylinder, keyed differently



- ☐ **40CKA**  
Mortise deadbolt lock with  
cylinder, keyed alike



- ☐ **99**  
Inside release thumbturn for  
mortise deadbolt lock



- ☐ **45**  
Mortise preparation for  
detention deadbolt lock



- ☐ **46**  
Detention deadbolt lock



- ☐ **47**  
CIDetention deadbolt Key

### OTHERS



- ☐ **60**  
Gasket



- ☐ **160**  
Holding cable



- ☐ **240**  
Masonry anchors