

RECESSED ACCESS DOOR WITH PLASTER BEAD FLANGE
Key-operated cylinder cam latch, piano hinge

AHA-PLY-10

INSTALLATION

Technical drawing AHA-PLY-10

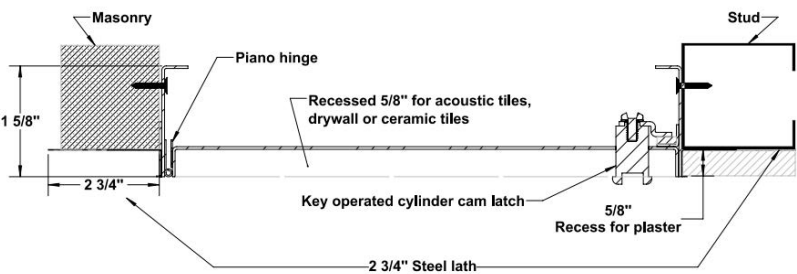

STANDARD DIMENSIONS AND APPEARANCE

Dimensions • W X H		Number of locks	Weight	
inches	mm		lbs	KG
8 x 8	203 x 203	1	3.5	1.6
12 x 12	304 x 304	1	6.5	3.0
16 x 16	406 x 406	1	9.7	4.4
18 x 18	457 x 457	1	11.7	5.3
24 x 24	609 x 609	1	19.1	8.7

Your odd sizes: Made in 5 days
Rough wall opening is door size + 1/4" or + 6 mm

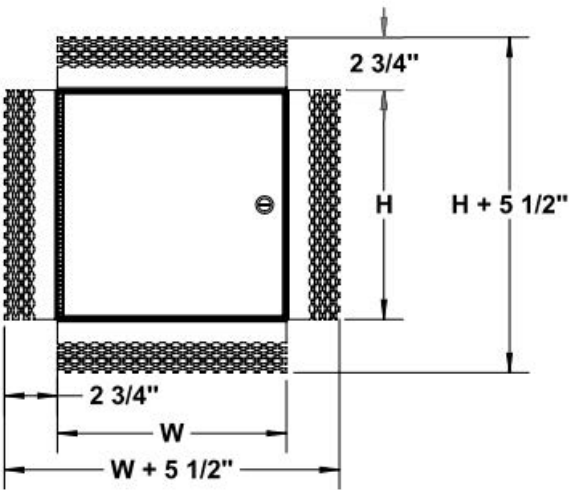

DESCRIPTION AND MATERIAL SPECIFICATION

Material	16 gauge cold rolled steel
Hinge	Continuous piano hinge, located on the second dimension (height)
Lock / Latch	Key-operated cylinder cam latch
Finish	High quality white powder coat primer
Packaging	Individually wrapped, 1 door per box
Flange	22-gauge galvanized steel, 2 3/4" plaster bead flange
Frame	1 5/8" in depth, made of cold rolled steel

POPULAR OPTIONS

For complete list of options go to [cendrex.com](https://www.cendrex.com)

Lock / Latch	Allen hex head cam latch (-50), screwdriver-operated cylinder cam latch (-220)
Material	Stainless steel (SS)
Recess	1/2" to 3/4" (standard 1 5/8" frame)

*Maximum recess 3/4"



PROJET DATA

Project:	Date:	QTY	W	H
Architech:				
Dealer:				
Contractor:				
Location:				

Tagging instructions:
Special instructions:
Options:
Submittal approval: (Signature or stamp)

OPTIONS

This comprehensive list includes all available options. Please consult our catalog or contact our customer service to verify the feasibility of your chosen combination.

LOW SECURITY LOCKING MECHANISM



- ☐ **35**
Screwdriver operated
cam latch



- ☐ **220**
Screwdriver operated
cylinder Cam latch



- ☐ **80**
Ring/tool key operated slam
latch



- ☐ **55**
Hex head slam latch and ring key
operated slam latch



- ☐ **30**
Slide latch



- ☐ **50**
Allen hex head cam latch

HANDLES



- ☐ **25**
WITH KEY - 4" handle and key
operated cam latch



- ☐ **100K**
Key-operated recessed handle
cam latch with cap over key
path



- ☐ **20**
WITHOUT KEY - 4" handle
operated cam latch



- ☐ **22**
WITHOUT KEY - 4" handle
operated slam latch



- ☐ **21**
WITHOUT KEY
Fixed 4" handle



- ☐ **26**
WITHOUT KEY - L handle

MEDIUM SECURITY LOCKING MECHANISM



- ☐ **10**
Key-operated cylinder
cam latch



- ☐ **15**
Mortise cam latch preparation
15C
Mortise cam latch preparation,
keyed differently
15CKA
Mortise cam latch preparation,
keyed alike



- ☐ **85**
Mortise slam latch



- ☐ **85C**
Mortise slam latch with cylinder
85CKA
Mortise slam latch cylinder
keyed alike



- ☐ **90**
Pinned hex head cam latch



- ☐ **C**
Cylinder cam latch,
keyed differently



- ☐ **CKA**
Cylinder cam latch,
keyed alike

MATERIALS



- ☐ **GS**
Galvanneal steel



- ☐ **AL**
Aluminum



- ☐ **SS**
Stainless steel



- ☐ **CR**
Cold rolled steel

HIGH SECURITY LOCKING MECHANISM



- ☐ **40**
Mortise deadbolt lock



- ☐ **40C**
Mortise Deadbolt Lock with
Cylinder, keyed differently



- ☐ **40CKA**
Mortise deadbolt lock with
cylinder, keyed alike



- ☐ **99**
Inside release thumbturn for
mortise deadbolt lock



- ☐ **45**
Mortise preparation for
detention deadbolt lock



- ☐ **46**
Detention deadbolt lock



- ☐ **47**
CIDetention deadbolt Key

OTHERS



- ☐ **60**
Gasket



- ☐ **160**
Holding cable



- ☐ **240**
Masonry anchors