

TECHNICAL DATA SHEET • SPECIFICATIONS

FIRE-RATED INSULATED ACCESS DOOR FOR HIGH SECURITY

Plaster bead flange, self-latching tool-key operated slam latch, piano hinge

PFI-PLY

INSTALLATION

Technical drawing PFI-PLY

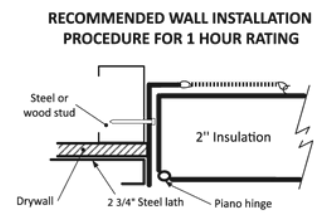
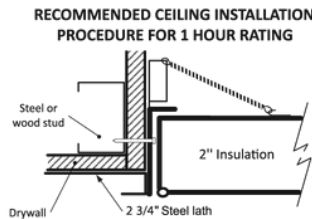
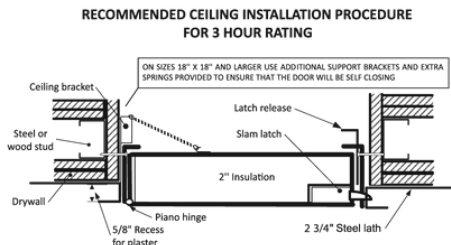

Authorities Having Jurisdiction (AHJ) should be consulted in all cases as to the particular requirements that apply to the installation and use of fire-rated access doors.

STANDARD DIMENSIONS AND APPEARANCE

Dimensions • W X H		Number of locks	Weight	
inches	mm		lbs	KG
8 x 8	203 x 203	1	6.6	3.0
10 x 10	254 x 254	1	8.6	3.9
12 x 12	304 x 304	1	11.0	5.0
14 x 14	355 x 355	1	13.4	6.1
16 x 16	406 x 406	1	15.9	7.2
18 x 18	457 x 457	1	18.8	8.5
22 x 22	558 x 558	1	25.5	11.6
22 x 30	558 x 762	1	32.1	14.6
22 x 36	558 x 914	2	38.4	17.5
24 x 24	609 x 609	1	28.8	13.1
24 x 36	609 x 914	2	40.8	18.5
*24 x 48	609 x 1219	2	50.6	23.0
*30 x 30	762 x 762	1	40.6	18.4
*32 x 32	812 x 812	2	45.6	20.7
*36 x 36	914 x 914	2	54.6	24.7
*48 x 48	1219 x 1219	2	84.9	38.5

Your odd sizes: Made in 5 days

Rough wall opening is door size + 1/4" or + 6 mm

For installation in vertical wall assemblies:

Certified to standards: UBC 7-2 (1997), UL 10B (1997), UL 10B (2009), NFPA 252 (2003), NFPA 252 (2008), NFPA 252 (2012), CAN/ULC S104 (R1985), CAN/ULC S104 (2010).

Rating achieved: 3 hours, neutral/negative pressure.

Maximum size: 48" wide x 48" high (1219 mm x 1219 mm). Maximum area of 2304 in². Tolerance on height and width limitation is ± 3" (76 mm) as long as the area does not exceed 2304 in².

Temperature rise: 250°F (121°C) after 30 min. 450°F (232°C) after 60 min.

For installation in horizontal ceiling assemblies:

Certified to standards: ASTM E119 (2012), CAN/ULC S101 (2007).

Rating achieved: 3 hours in non-combustible construction. 1 hour in combustible construction.

Maximum size: 24" x 36" (hinges & latch on 36" long sides) (610 mm x 914 mm). tolerances on dimension limitations are ± 3" (76 mm) as long as the area does not exceed 864 in².

Temperature rise: not applicable.

PROJECT DATA

Project:	Date:	QTY	W	H
Architech:				
Dealer:				
Contractor:				
Location:				

DESCRIPTION AND MATERIAL SPECIFICATION

Material	20-gauge galvaneal steel door and 16-gauge cold rolled steel frame
Hinge	Continuous piano hinge, located in the second dimension (height)
Lock / Latch	Self-latching tool-key operated slam latch and/or ring operated slam latch, both included
Finish	High quality white powder coat primer
Packaging	Individually wrapped, 1 door per box
Inside panel release	Mechanism allowing panels to open from inside, standard on all doors over 12" x 12"
Flange	22-gauge galvanized steel, 2 3/4" drywall bead flange
Frame	2 1/2" in depth, made of cold rolled steel
Insulation	2" thick fire rated mineral wool

POPULAR OPTIONS

For complete list of options go to cendrex.com

Lock / Latch	Key-operated cylinder cam latch (-10), mortise slam latch (-85, cylinder optional)
Handle	4" handle-operated slam latch (-22)
Material	Stainless Steel (SS)

OTHER TECHNICAL INFORMATION

*Not available for ceiling rating (maximum 24" x 36")

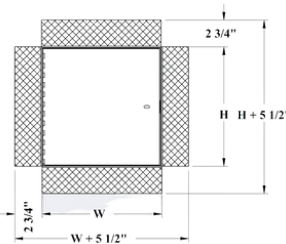

OPTIONS

This comprehensive list includes all available options. Please consult our catalog or contact our customer service to verify the feasibility of your chosen combination.

LOW SECURITY LOCKING MECHANISM



- 35** Screwdriver operated cam latch



- 220** Screwdriver operated cylinder Cam latch



- 80** Ring/tool key operated slam latch



- 55** Hex head slam latch and ring key operated slam latch



- 30** Slide latch



- 50** Allen hex head cam latch

HANDLES



- 25** WITH KEY - 4" handle and key operated cam latch



- 100K** Key-operated recessed handle cam latch with cap over key path



- 20** WITHOUT KEY - 4" handle operated cam latch



- 22** WITHOUT KEY - 4" handle operated slam latch



- 21** WITHOUT KEY Fixed 4" handle



- 26** WITHOUT KEY - L handle

MEDIUM SECURITY LOCKING MECHANISM



- 10** Key-operated cylinder cam latch



- 15** Mortise cam latch preparation
- 15C** Mortise cam latch preparation, keyed differently
- 15CKA** Mortise cam latch preparation, keyed alike



- 85** Mortise slam latch



- 85C** Mortise slam latch with cylinder
- 85CKA** Mortise slam latch cylinder keyed alike



- 90** Pinned hex head cam latch



- C** Cylinder cam latch, keyed differently



- CKA** Cylinder cam latch, keyed alike

MATERIALS



- GS** Galvanneal steel



- AL** Aluminum



- SS** Stainless steel



- CR** Cold rolled steel

HIGH SECURITY LOCKING MECHANISM



- 40** Mortise deadbolt lock



- 40C** Mortise Deadbolt Lock with Cylinder, keyed differently



- 40CKA** Mortise deadbolt lock with cylinder, keyed alike



- 99** Inside release thumbturn for mortise deadbolt lock



- 45** Mortise preparation for detention deadbolt lock



- 46** Detention deadbolt lock



- 47** CIDetention deadbolt Key

OTHERS



- 60** Gasket



- 160** Holding cable



- 240** Masonry anchors